



2019020939 00120

FORSYTH CO, NC FEE \$26.00

PRESENTED & RECORDED:

06-04-2019 02:26:51 PM

LYNNE JOHNSON

REGISTER OF DEEDS

BY: OLIVIA DOYLE

ASST

BK: RE 3463

PG: 4225-4227

D-28543

APPROVED

**ORDINANCE DESIGNATING CERTAIN PROPERTY
AS A HISTORIC LANDMARK**

WHEREAS, all of the prerequisites to the adoption of this ordinance as prescribed by Chapter 160A, Article 19, Part 3C of the North Carolina General Statutes have been met; and

WHEREAS, the Forsyth County Historic Resources Commission has submitted a report, which is incorporated herein by reference, and recommends after a separate public hearing that the property described below be designated a historic landmark; and

WHEREAS, the City Council after a separate public hearing finds that the property described herein is of historical, architectural, and/or cultural significance, and the property's preservation should be encouraged, and that the qualifying elements exist as set forth in the Historic Resources Commission report.

NOW, THEREFORE, BE IT ORDAINED by the City Council of the City of Winston-Salem, as follows:

Section 1. The following described property is hereby designated a historic landmark:

YWCA Administration Building, 1201 Glade Street, specifically the complete exterior of the building, and the tax block and lot upon which it sits (Tax Block 0122, Lot 105A/PIN #6825-76-5652.00). This property is owned by West End Renaissance Residence Development, LLC.

Section 2. The review process provided by law shall be observed prior to demolition, alteration, rehabilitation, or removal of the designated property.

Section 3. This ordinance shall be effective from and after its adoption.

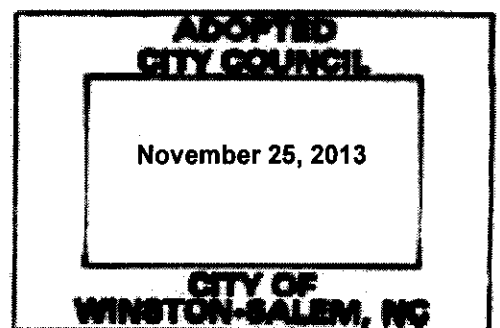

City
Box 5

EXHIBIT

THIS MAP MAY NOT BE A CERTIFIED SURVEY AND HAS NOT BEEN REVIEWED BY A LOCAL GOVERNMENT AGENCY FOR COMPLIANCE WITH ANY APPLICABLE LAND DEVELOPMENT REGULATIONS AND HAS NOT BEEN REVIEWED FOR COMPLIANCE WITH RECORDING REQUIREMENTS FOR PLATS.

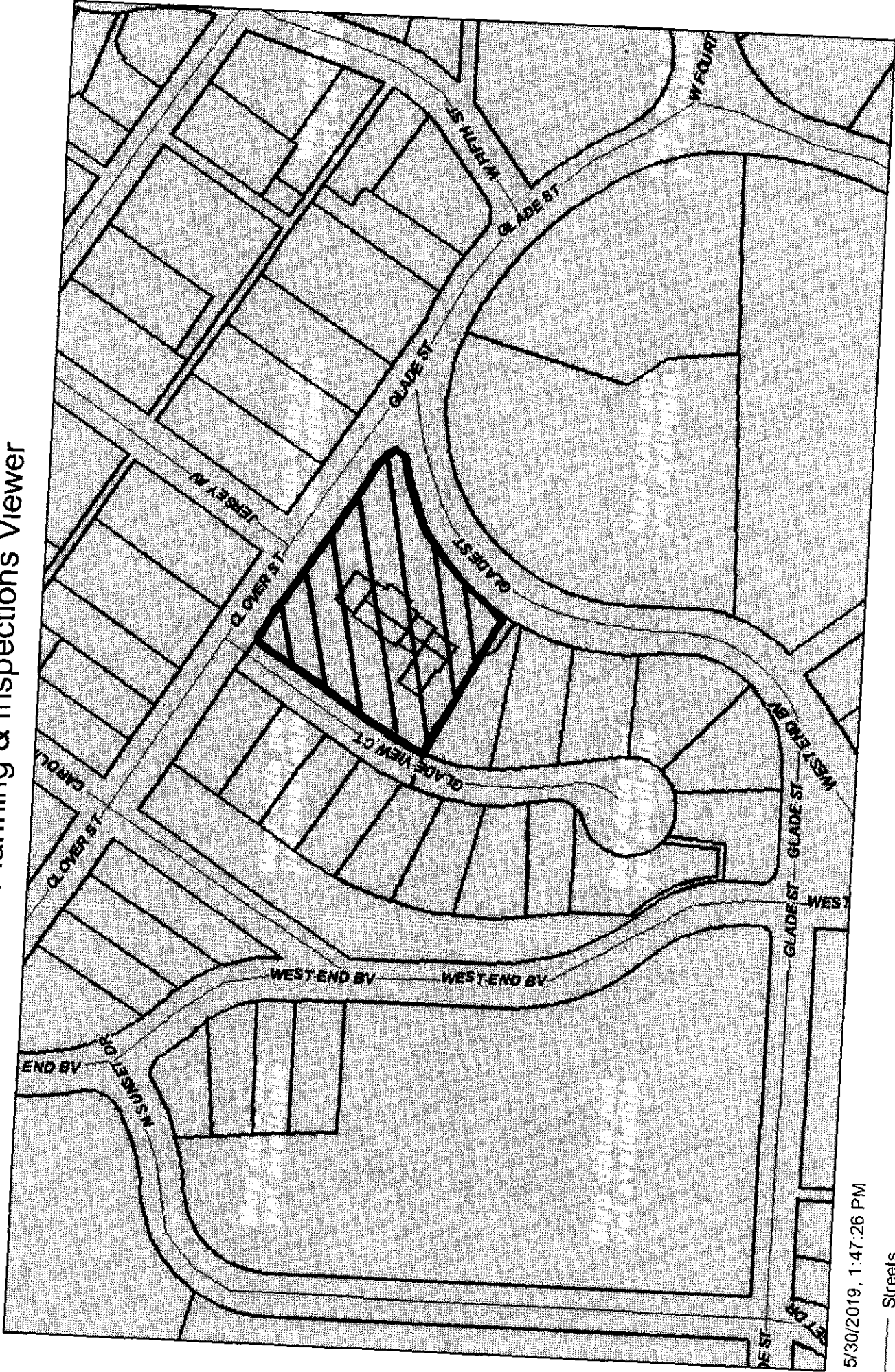

5/30/2019, 1:47:26 PM

Streets

Local Historic Landmarks

Parcels

1:2,257
0 0.0175 0.035 0.07 mi
0 0.03 0.06 0.12 km
Esri, HERE, Garmin, (c) OpenStreetMap contributors, and the GIS user community